





## CARLISLE PLACE, LONDON SW1P 1NH

A grand and laterally spacious 3rd floor apartment within a sought-after mansion building comprising 3 generously proportioned Reception Rooms, three double bedrooms and two bathrooms (1 en suite) and kitchen with adjoining breakfast room. This well presented and gracious apartment with impressive period scale retains numerous period features and benefits from high ceilings, a balcony off the reception room and several period fireplaces. The building enjoys the benefits of a lift and day portage.

Evelyn Mansion is a well-regarded Mansion building on Carlisle Place immediately off Victoria Street and within easy reach of Victoria Station (National Rail including Gatwick Express and both District and Circle and Victoria underground lines). St James's Park is also close by along with a plethora of famous London landmarks, theatres, shops, bars and restaurants.

### Accommodation & Amenities

- Third Floor
- Master bedroom with en suite bathroom
- 2 further bedrooms
- 2,433 sq ft
- Leasehold with 130 years unexpired
- Westminster Council tax band G

**£2,000,000 ASKING PRICE SUBJECT TO CONTRACT**

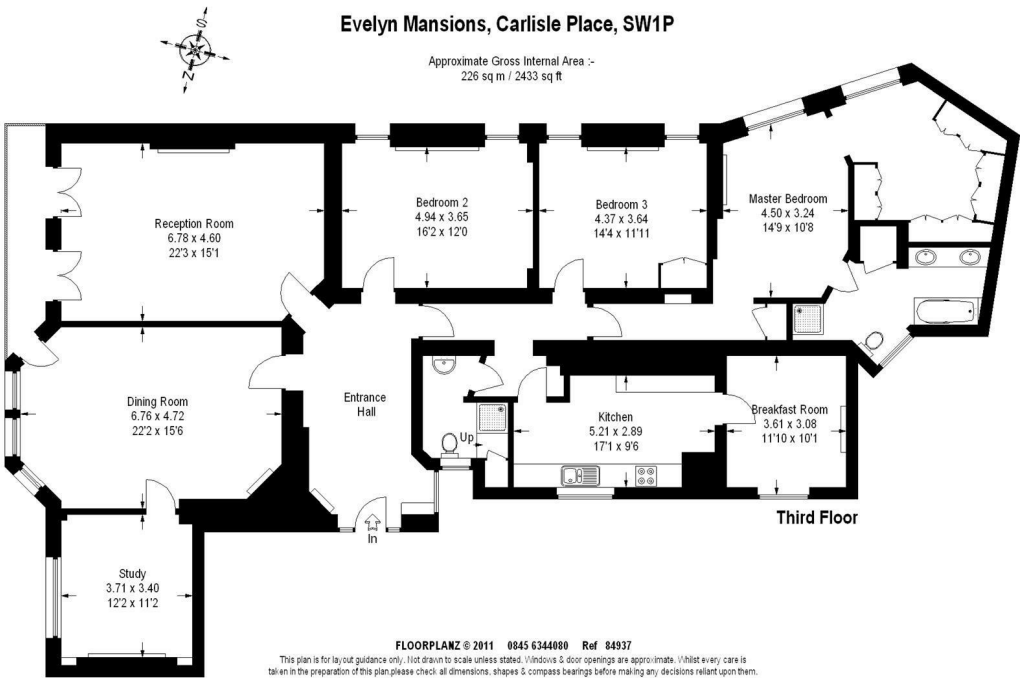

Approximate Gross Internal Area  
2433.00 sq ft

Energy Efficiency Rating		
	Current	Potential
Very energy efficient - lower running costs		
(92 plus) A		85
(81-91) B		
(69-80) C		
(55-68) D	67	
(39-54) E		
(21-38) F		
(1-20) G		
Not energy efficient - higher running costs		
England & Wales		EU Directive 2002/91/EC







440 Kings Road, London, SW10 0LH

02073512383

[sales@aylesford.com](mailto:sales@aylesford.com)

[www.aylesford.com](http://www.aylesford.com)

**AYLESFORD**  
INTERNATIONAL

These plans are for guidance only and must not be relied upon as statement of fact. Attention is drawn to the important notice. Important notice 1. Particulars: These particulars are not an offer or contract, nor part of one. You should not rely on statements by Aylesford in the particulars or by word of mouth or in writing ("information") as being factually accurate about the property, its condition or its value. Neither Aylesford nor any joint agent has any authority to make any representations about the property, and accordingly any information given is entirely without responsibility on the part of the agents, seller(s) or lessor(s). 2. Photos etc: The photographs show only certain parts of the property as they appeared at the time they were taken. Areas, measurements and distance given are approximate only. 3. Regulations etc: Any reference to alterations to, or use of, any part of the property does not mean that any necessary planning, building regulations or other consent has been obtained. A buyer or lessee must find out by inspection or in other ways that these matters have been properly dealt with and that all information is correct. 4. VAT: The VAT position relating to the property may change without notice.